

项目 Mxd	变更内容 Modification	日期 Date	修改人 Draw	核准 Approve
-----------	----------------------	------------	-------------	---------------

规格说明: Specifications:
电气特性: Electrical:

1. 额定电流: Current Rating

1.5A/contact terminal
2. 额定电压: Voltage Rating
30V DC

3. 接触电阻: Contact Resistance
30 milliohms MAX

4. 耐电压: Dielectric Withstanding Voltage:
500 V AC AT Sea Level

5. 绝缘电阻: Insulation Resistance:
1000MEGA ohms MIN

物理性能: Mechanical:

1. 插拔力: Connector Mate and Unmate Force
Mate force: 3.57kgf(MAX)
Unmate force: 1.02kgf(MIN)

原材料: Material:

1. 塑壳: Housing:
Hing Temperature Thermoplastics,

2. 端子: Contact: Copper Alloy C2680

3. 外壳: Shell: Copper Alloy C2680/SPCC

电镀: Finish: 1. 端子: Contact: Plated Gold in Mating Area
Tin On Solder Tails

2. 外壳: Shell: 端子四周镀50U”(MIN)镍,镀金区域镀100—200U”镀金1U”

3. 外壳: Shell: 铜壳四周镀80U”(MIN)镍

Nickel Plating

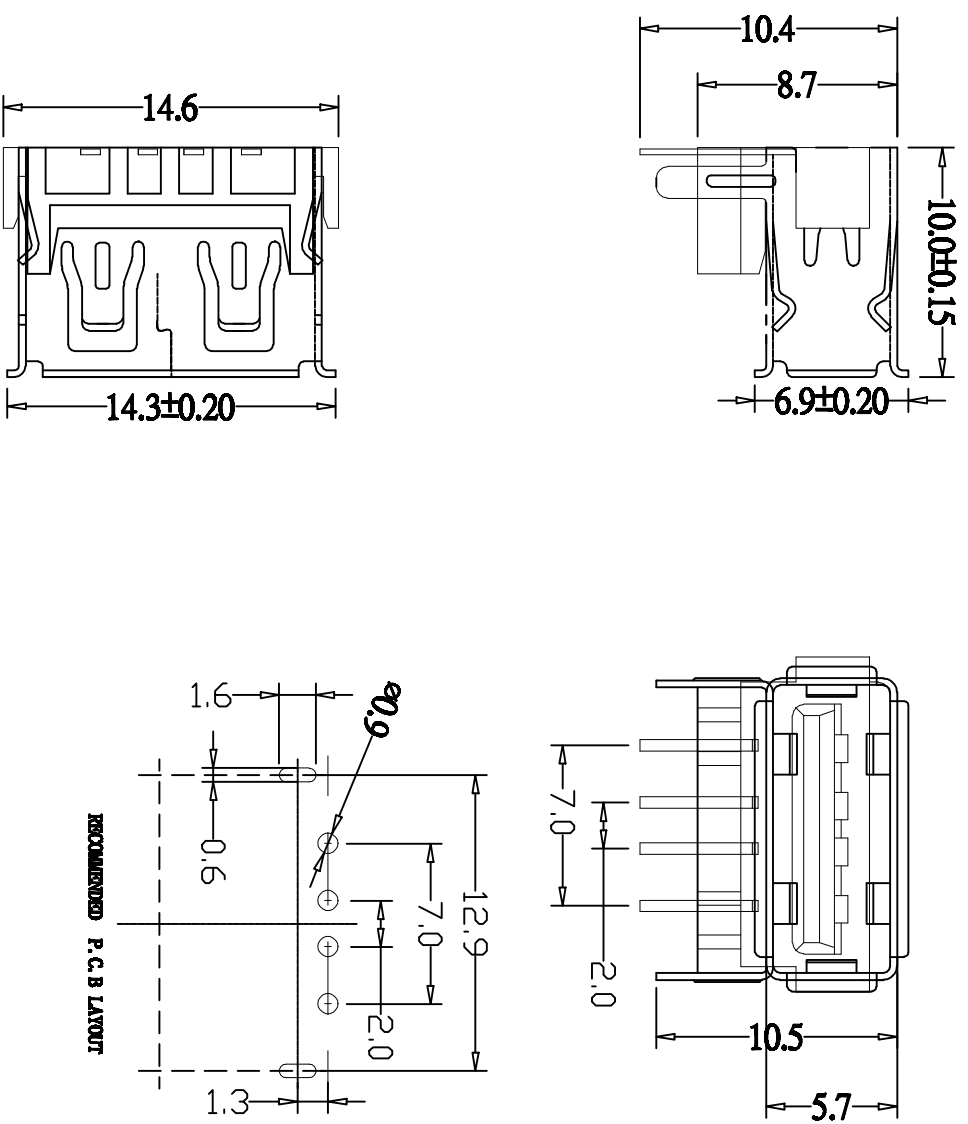

Shenzhen City Xiangyunfeiwu Technology Co., Ltd.

图号 MANUFACTURE DWG 公差一覽表 TOLERANCE UNLESS OTHERWISE	日期 DATE	比例 SCALE	姓名 NAME	图号 DRAWING NO.
X±0.20	2016.10.20	1:1	陈伟雄	87(90度)母座
XX±0.10	X±2°	1:1	陈伟雄	87(90度)母座
XXX±0.02	XX±1°	角差	陈伟雄	87(90度)母座