

PCB LAYOUT

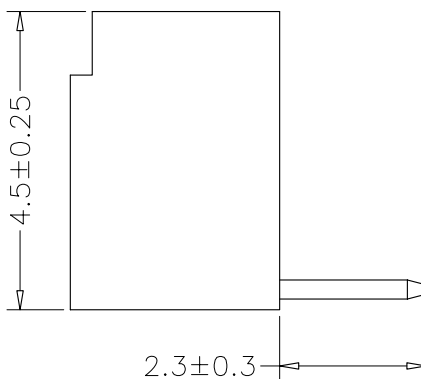
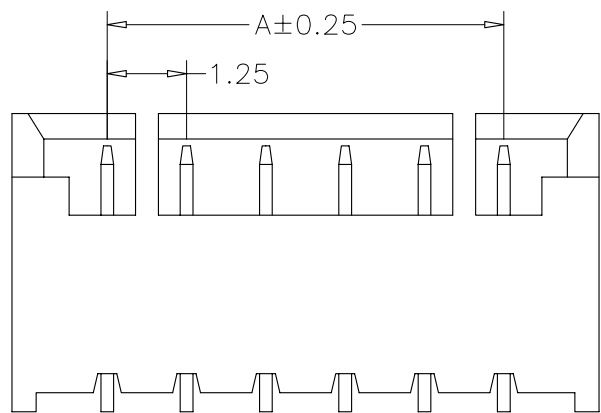

Dimension: $A = (\text{Pos}-1) * 1.25$

$B = A + 3.00$

Wafer (Right Angle)

Positions : 2~15 Circuits

Insulator : Nylon-66 UL94V-0

Contact : Phosphor Bronze

Plated : Tin-plated 50u" Min

Color : White

SPECIFICATIONS

Current Rating : 1AMP

Temperature Range : -40° C to +105° C

Contact Resistance : 20mΩ Max

Insulation Resistance: 1000MΩ Min

Withstanding Voltage : AC 500V

XYFW(www.cnxyfw.com)

未注公差	X: ±0.35	品名规格	1.25 wafer 90度			
	X.X: ±0.25		客户品号			
	X.XX: ±0.20					
	X.XXX: ±0.15					
Size:A4	UNIT:mm	版本	制图	审核	核准	日期
Scale:1:1	☉ □	A/0	易红	王笑		2008-9-9